

Print Date:
December 7, 2004

Can O LokTM Pipe

OPEN TRENCH PIPE DIMENSIONS IN INCHES

Average Approximate Dimensions - Allow +/- 2%

Please Consult Factory for Current Dimensions

Specifications Subject to Change without Notice

Isoprene Seals Can Be Replaced By Nitrile or EPDM For Specials Conditions

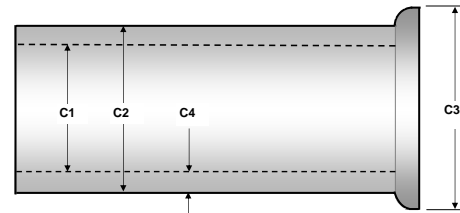

JOINT DETAILS

Note: 32", 39", 42" and 48" Diameters Use NoBel Low Profile Joint

Nominal Size	Last Revision Date	Inside Diameter	Outside Diameter	Bell Diameter	Wall Thickness	Maximum Length	Bell Length	Bell Shoulder	Bell Type Type of Joint	Standard Sealing Material	Optional Sealing Material	3 Edge Bearing Strength Minimum Pounds/Ft.	Approx. weight per Foot Pounds	Pieces per Package
4" (100mm)	26-Apr-00	3.94	5.24	7.95	0.65	54	1.75	3.00	Vitrified Clay	Polyurethane Joint	None	2000	9	70
6" (150 mm)	26-Apr-00	5.94	7.40	10.12	0.73	54	2.25	3.50	Vitrified Clay	O-Ring - Isoprene	EPDM/Neoprene	2000	16	40
8" (200 mm)	26-Apr-00	7.83	9.80	13.11	0.98	66	2.75	4.13	Vitrified Clay	O-Ring - Isoprene	EPDM/Neoprene	2200	27	28
10" (250 mm)	26-Apr-00	10.00	12.05	15.28	1.02	72	2.56	4.13	Vitrified Clay	O-Ring - Isoprene	EPDM/Neoprene	2400	40	18
12" (300 mm)	26-Apr-00	11.97	14.21	17.36	1.12	72	2.87	4.50	Vitrified Clay	O-Ring - Isoprene	EPDM/Neoprene	2600	54	15
15" (375 mm)	26-Apr-00	14.96	17.99	22.28	1.52	90	2.75	4.63	Vitrified Clay	O-Ring - Isoprene	EPDM/Neoprene	2900	89	8
18" (450 mm)	26-Apr-00	18.94	22.44	26.77	1.75	120	2.87	5.50	Vitrified Clay	O-Ring - Isoprene	EPDM/Neoprene	3300	130	6
21" (500 mm)	26-Apr-00	20.80	25.73	31.50	2.47	120	3.50	6.00	Vitrified Clay	O-Ring - Isoprene	EPDM/Neoprene	3850	179	1
24" (600 mm)	26-Apr-00	24.33	29.37	35.35	2.52	120	3.25	7.13	Vitrified Clay	O-Ring - Isoprene	EPDM/Neoprene	4400	228	1
27" (700 mm)	26-Apr-00	26.97	33.15	38.35	3.09	120	4.13	8.38	Vitrified Clay	O-Ring - Isoprene	EPDM/Neoprene	4700	262	1
30" (750 mm)	26-Apr-00	29.53	35.39	42.00	2.93	120	4.38	8.50	Vitrified Clay	O-Ring - Isoprene	EPDM/Neoprene	5000	310	1
32" (800 mm)	26-Apr-00	31.10	37.40	38.90	3.15	120	0.00	0.00	316 Stainless/GRP	Polyurethane Joint	None	5500	341	1
36" (900 mm)	26-Apr-00	35.04	42.48	50.75	3.72	120	4.00	8.00	Vitrified Clay	O-Ring - Isoprene	EPDM/Neoprene	6000	452	1
39" (1000 mm)	26-Apr-00	39.02	46.97	48.54	3.98	120	0.00	0.00	316 Stainless/GRP	Polyurethane Joint	None	6600	538	1
42" (1100 mm)	26-Apr-00	42.72	51.34	53.03	4.31	120	3.50	7.76	316 Stainless/GRP	Polyurethane Joint	None	7000	650	1
48" (1200 mm)	26-Apr-00	47.44	57.64	59.45	5.10	120	0.00	0.00	316 Stainless/GRP	Polyurethane Joint	None	7400	786	1